

# Playground

Y2 enter through playground doors

Y1 enter through playground doors

Y3 enter by far side door then up the stairs

Y4 enter by back door and go straight up the stairs.

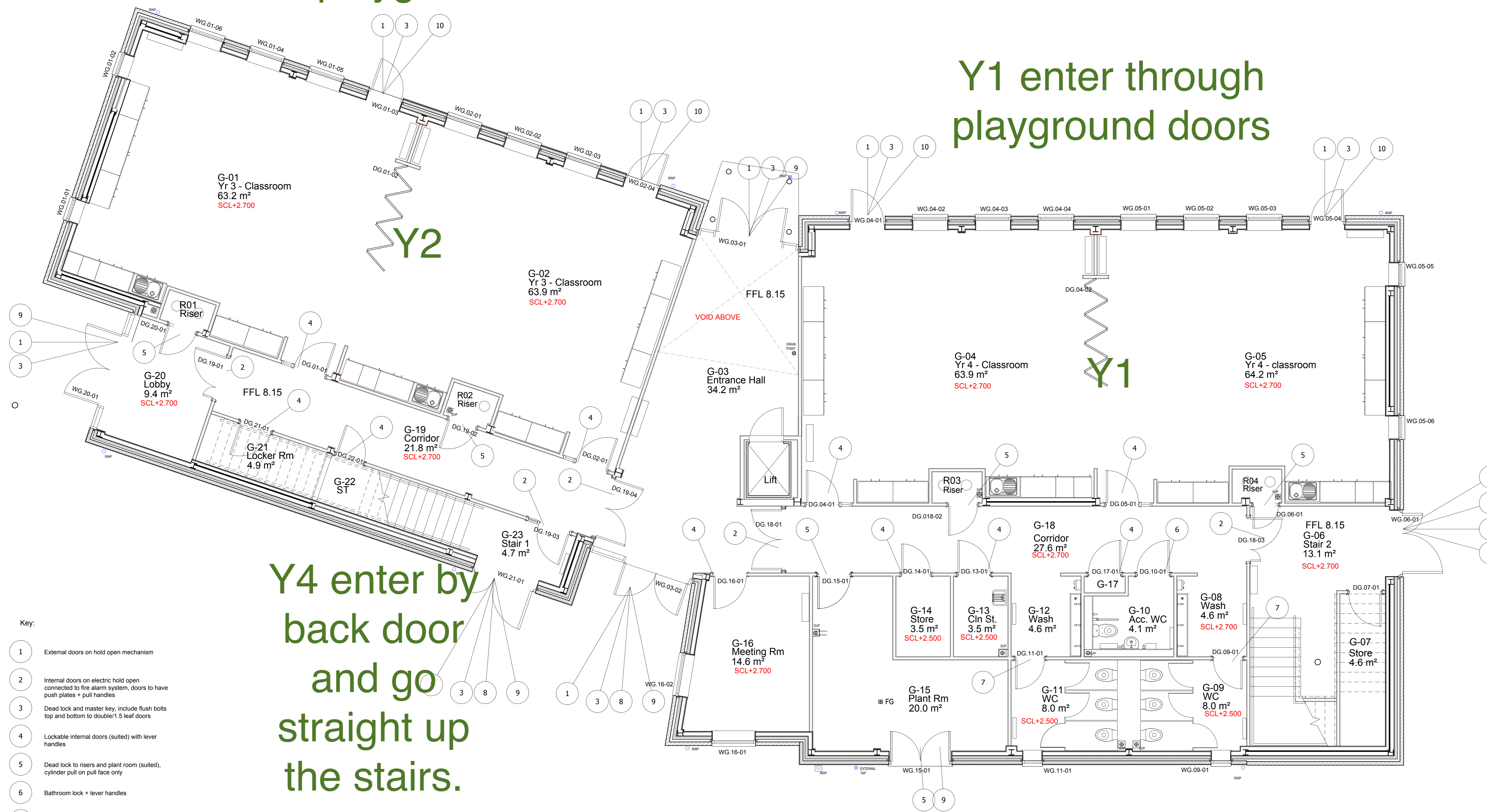

**Key:**

- 1 External doors on hold open mechanism
- 2 Internal doors on electric hold open connected to fire alarm system, doors to have push plates + pull handles
- 3 Dead lock and master key, include flush bolts top and bottom to double/1.5 leaf doors
- 4 Lockable internal doors (suited) with lever handles
- 5 Dead lock to risers and plant room (suited), cylinder pull on pull face only
- 6 Bathroom lock + lever handles
- 7 No lock, push plates + pull handles
- 8 Panic hardware with vertical bolt
- 9 Push Plates/Pull Handles (external doors)
- 10 Lever Handles with Latch (external doors)

**Notes:**

No electronic access required to external doors  
 All ironmongery to be DDA and building regs compliant  
 Refer to ironmongery schedule for details of ironmongery to internal doors

**NOTES**  
 Report all discrepancies, errors and omissions.  
 Do not scale from this drawing.  
 Verify all dimensions on site before commencing any work or preparing shop drawings.  
 All materials, components and workmanship are to comply with all the relevant British Standards, Codes of Practice, and appropriate manufacturers recommendations that from time to time shall apply.  
 For all specialist work, see relevant drawings.  
 This drawing and design are copyright of PELLINGS LLP

**CONSTRUCTION**

Rev	Date	Description	Name
005	08.11.17	FURTHER INFORMATION ADDED TO KEY	
004	08.11.17	DOOR SCHEDULE CHANGED TO MATCH ROOM DOOR CODES CHANGED TO	
003	08.11.17	EXTERNAL DOORS WITH FRAME AND WINDING DRAWING STATES UPDATES	
002	08.11.17	EXTERNAL DOOR TO CLASSROOMS REDESIGNED BY WORKS WITH SCHOOL, HANDLE POSITION AND HANDLE ACCESS	

**Pellings**

Pellings LLP  
 24 Rotherham Road, Doncaster, North Yorkshire YO1 1HT  
 T: 01524 646019 M: 01524 635100 E: info@pellings.co.uk  
 www.pellings.co.uk

Architecture & Planning • Building Surveying • Project Management •  
 Cost Consultancy • CDM Coordination

CLIENT  
**NEILCOTT**

PROJECT  
**ST MARYS CATHOLIC  
 PRIMARY SCHOOL  
 645.014**

TITLE  
**ACCESS STRATEGY  
 GROUND FLOOR**

DATE	SCALE	DRAWN
10-16	1:50 @ A0	MJG